

Mast range

M 30 = HEB 160 - 220

M 36 = HEB 240 - 260

Note

Anchor bolt 1444.24

Sleeve frame for mast
connection (8 x M 24) 1422

When ordering, please state gradient.

Gradient negative (N) $0^\circ - 20^\circ$

Anchor bolt M24 and hexagonal screws

M24x100 with washer M24

must be ordered separately.

The static proof for the mast bracket and
the indication of the effect on the structure
are required in any case.

The proof of the wall bolts is provided by the customer.

When ordering state length A.

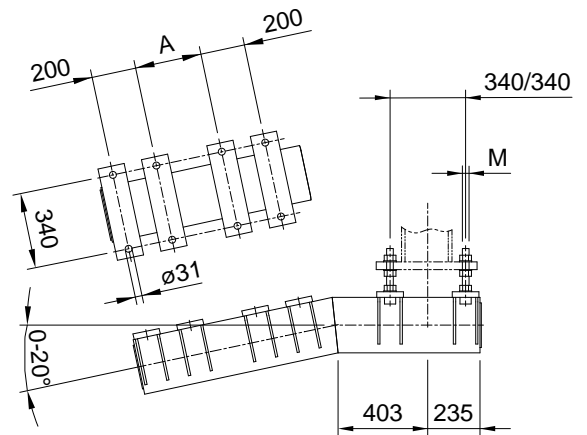
**Drawing number**

A drawing is made individual for each order

Ordering informationwith thread M30, gradient negative 15° , $A=300$

1416.30.N15.300 Mast connection to
concrete structure